

MOUNTING

Motor with coupling MTV 40

STEP 1: Insert centering ring to the linear unit and attach one half of the coupling to the linear unit. Attach connector plate to the motor.

STEP 2: Attach other half of the coupling to the motor and insert coupling spider to either half of the coupling. Attach connector body to the linear unit.

STEP 3: Align coupling halves and join connector plate and body.

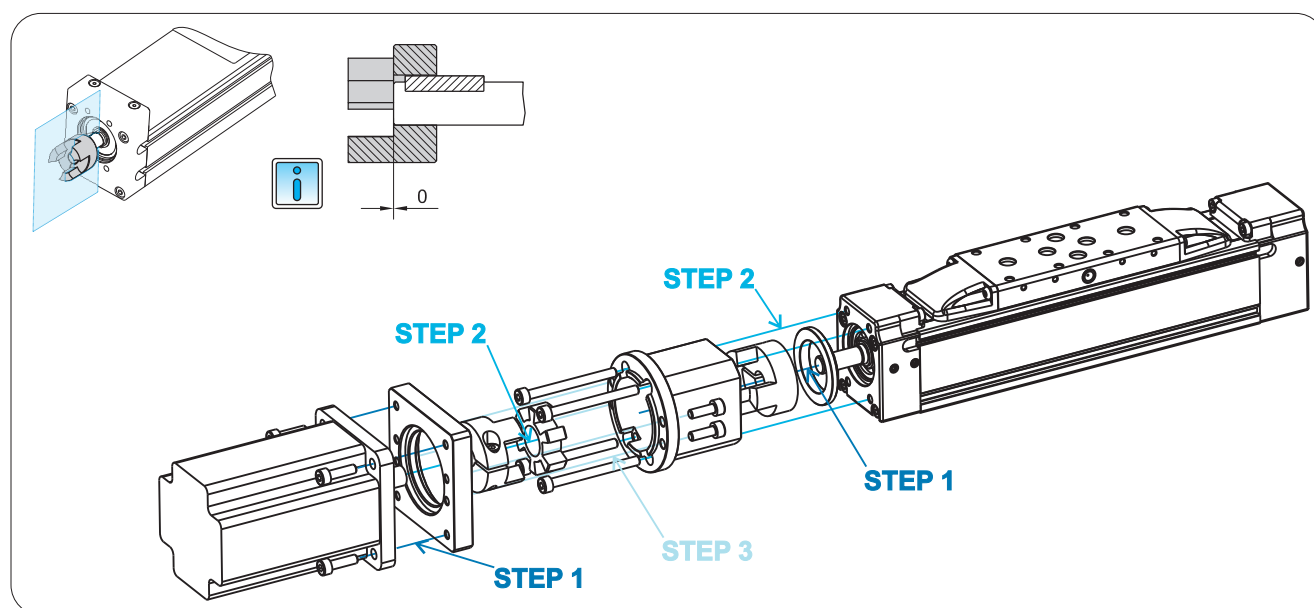

Tighten the screws on the coupling halves with coupling tightening torque.



! The maximum torque and maximum speed of the motor must never exceed the limits of the Linear Unit!



For tightening torques for the screws please refer to page number 1.005.0